



Hercules® RetroDrain®

PRODUCT DATA SPECIFICATIONS

PRODUCT DESCRIPTION

Hercules RetroDrains have a one-piece spun aluminium body, heavy-duty cast aluminium strainer dome and a clamping ring for strength and durability. The Hercules RetroDrain incorporates U-Flow® Seal technology for a mechanical watertight connection to PVC or cast-iron pipes to prevent water from backup damage. Available in 75 mm (3"), 100 mm (4"), 125 mm (5") and 150 mm (6") sizes. Hercules RetroDrains, the industry's most popular retrofit drain, are available with a variety of options to support any project, including TPO- or PVC-coated flanges for direct membrane attachment or copper stem and flange for more corrosive environments.

FEATURES & BENEFITS

- One-piece seamless body provides strength and durability without separation of the flange from the stem.
- Extra-large 445 mm (17.5") flange allows positive attachment of roof flashing membrane while the sump area facilitates drainage.
- Cast-aluminium strainer dome and clamping ring. (Clamping ring not used with TPO- or PVC-coated drains).
- 305 mm (12") long drain stem accommodates most existing field conditions.
- Saves time and money by allowing easy installation from the rooftop without disturbing occupants.
- Cast aluminium SuperDome® available with flip-top lid for easy cleaning.

APPROVALS & STANDARDS

ANSI/SPRI RD-1 is a US performance standard for retrofit roof drains. While most drains are not tested to this standard, Hercules RetroDrains exceed the standard, which requires the seal to hold a 3 m (10 ft.) column of water for 24 hours without leaking.



ULC/ORD-C790.4 – developed by Underwriters' Laboratories of Canada and features a test protocol designed to assure a leak-free connection to existing plumbing and impact testing to provide strength.



PHYSICAL DATA

The data below is constant for each Hercules RetroDrain.

DRAIN BODY	SEAL
3.2 mm (.125") spun aluminium	Watertight U-Flow mechanical seal requires U-Flow screwdriver
FLANGE	STRAINER DOME
445 mm (17½") diameter with sump area	Cast aluminium
STEM	CLAMP RING
305 mm (12") length	Cast aluminium or thermoplastic coated

Hercules



Copper Hercules

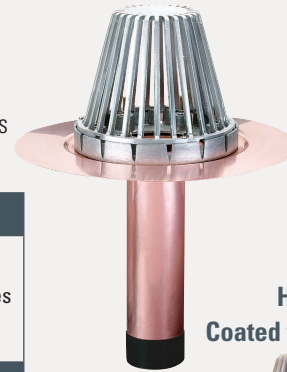

Hercules Coated for PVC or TPO



ORDERING INFORMATION

PRODUCT	CAT. NO.	DOME TYPE	PKG QTY	WEIGHT KGS (LBS)
75 mm (3") Hercules	HDAL3A	Aluminium	1	12.2 (27)
100 mm (4") Hercules	HDAL4A	Aluminium	1	12.2 (27)
125 mm (5") Hercules	HDAL5A	Aluminium	1	12.2 (27)
150 mm (6") Hercules	HDAL6A	Aluminium	1	12.2 (27)
75 mm (3") Hercules (TPO-Coated Flange)	HDTPO3A	Aluminium	1	12.2 (27)
100 mm (4") Hercules (TPO-Coated Flange)	HDTPO4A	Aluminium	1	12.2 (27)
125 mm (5") Hercules (TPO-Coated Flange)	HDTPO5A	Aluminium	1	12.2 (27)
150 mm (6") Hercules (TPO-Coated Flange)	HDTPO6A	Aluminium	1	12.2 (27)
75 mm (3") Hercules (PVC-Coated Flange)	HDPVC3A	Aluminium	1	12.2 (27)
100 mm (4") Hercules (PVC-Coated Flange)	HDPVC4A	Aluminium	1	12.2 (27)
125 mm (5") Hercules (PVC-Coated Flange)	HDPVC5A	Aluminium	1	12.2 (27)
150 mm (6") Hercules (PVC-Coated Flange)	HDPVC6A	Aluminium	1	12.2 (27)
75 mm (3") Hercules (Copper)	HDCU3A	Aluminium	1	12.2 (27)
100 mm (4") Hercules (Copper)	HDCU4A	Aluminium	1	12.2 (27)
125 mm (5") Hercules (Copper)	HDCU5A	Aluminium	1	12.2 (27)
150 mm (6") Hercules (Copper)	HDCU6A	Aluminium	1	12.2 (27)



Hercules® RetroDrain®

INSTALLATION PROCEDURE

FOR USE WITH

All types of roof covers.

JOB PREPARATION

Remove existing strainer dome and clamping ring. Remove other existing drain components as required to enable the Hercules Drain flange to lie flush on roof membrane. Remove any debris or constricting materials in the existing drain pipe that interferes with proper installation.

STEP 1

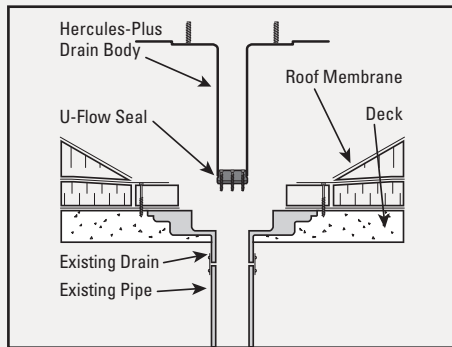

Examine the existing water leader to make sure there are no elbows that prevent the drain stem from being fully inserted into the pipe. Insert U-Flow® Seal into end of drain stem and tighten screws enough to hold the seal in place during installation. Insert assembled drain into existing leader pipe until flange lies flush on roof membrane.

STEP 2

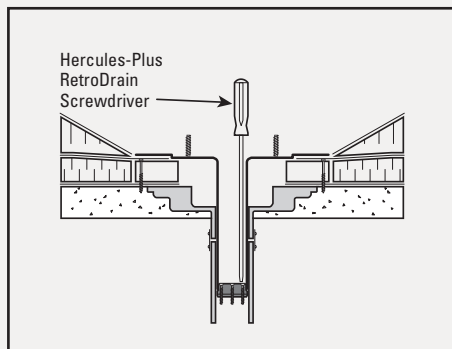

Alternately tighten seal compression ring screws with a U-Flow Screwdriver until hand

tight. Hercules-Plus is correctly installed when pressure placed on the drain body results in no vertical movement. Do not overtighten the screws.

STEP 3

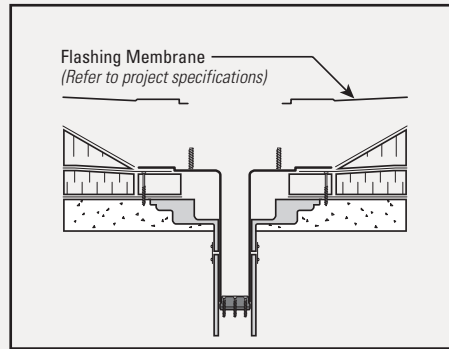

Secure the drain flange to the roof surface/nailer using a minimum of three pan-head fasteners, evenly spaced around the flange. The flashing membrane must cover and extend past the fastener head. Flashing membrane must be installed as per roof membrane manufacturer's instructions. For TPO-/PVC-coated flange, hot-air weld the flashing membrane to the drain flange.

STEP 4

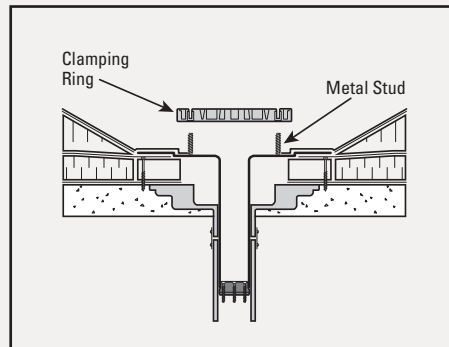

Place clamping ring over the metal studs. Install stainless steel nut and lock washers, tightening clamping ring against the membrane flashing until secure.

STEP 5

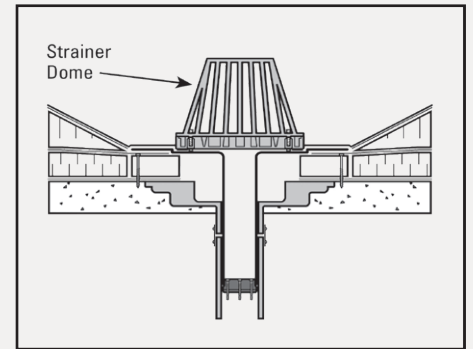

Install strainer dome by aligning screw holes with the holes in the clamping ring. Secure with screws provided.

HOW TO SHORTEN AN OLYFLOW® RETROFIT DRAIN

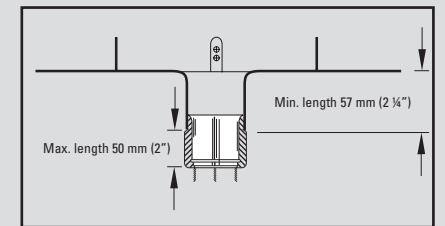

Make sure there is at least 100 mm (4") of clear vertical distance in the existing pipe to accommodate the drain. Cut drain stem to desired length and insert U-Flow Seal. Note: Leave at least 65 mm (2.5") of the drain stem to accommodate the seal.

Insert the U-Flow Seal in the cut drain stem and tighten the seal screws. Once the drain and seal have been assembled, insert it into the existing water leader and complete the assembly following installation steps 2 to 5.

**For technical assistance contact
OMG on +1 800 633 3800.**



ROOFING PRODUCTS

153 BOWLES ROAD,
AGAWAM, MA 01001 USA
+1 413.789.0252
INFOEUROPE@OLYFAST.COM
WWW.OMGROOFING.COM

Superior productivity. Superior performance.

Europe Market Manager:
Lennard Spirig
LSpirig@olyfast.com
Mob: +41 79 200 19 30
Office: +41 71 599 19 30

Benelux:
Ruud Veldwijk
RVeldwijk@olyfast.com
Mob: +31 6 28376030

United Kingdom:
Mick Steeples
MSteeples@olyfast.com
Mob: +44 7824 364850

Hercules®, RetroDrain®, OlyFlow®, SuperDome® and U-Flow® are trademarks of OMG, Inc.
Copyright © 2019 OMG, Inc. All rights reserved.

